

NOTES

NOTES:
Cladding and coping to be Algerian Stone (50mm thick, sandblast finish) by Owen Sound Ledgerrock.

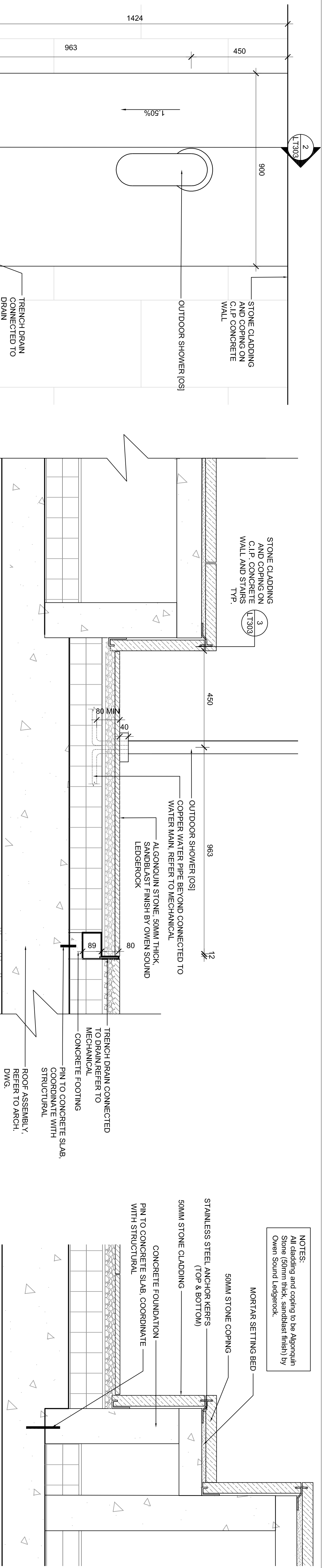

1 OUTDOOR SHOWER AREA - PLAN
SCALE: 1 : 10

2 OUTDOOR SHOWER AREA - SECTION
SCALE: 1 : 10

3 STONE CLADDING AND COPING ON CLIP CONCRETE WALL AND STAIRS TYP.
SCALE: 1 : 10

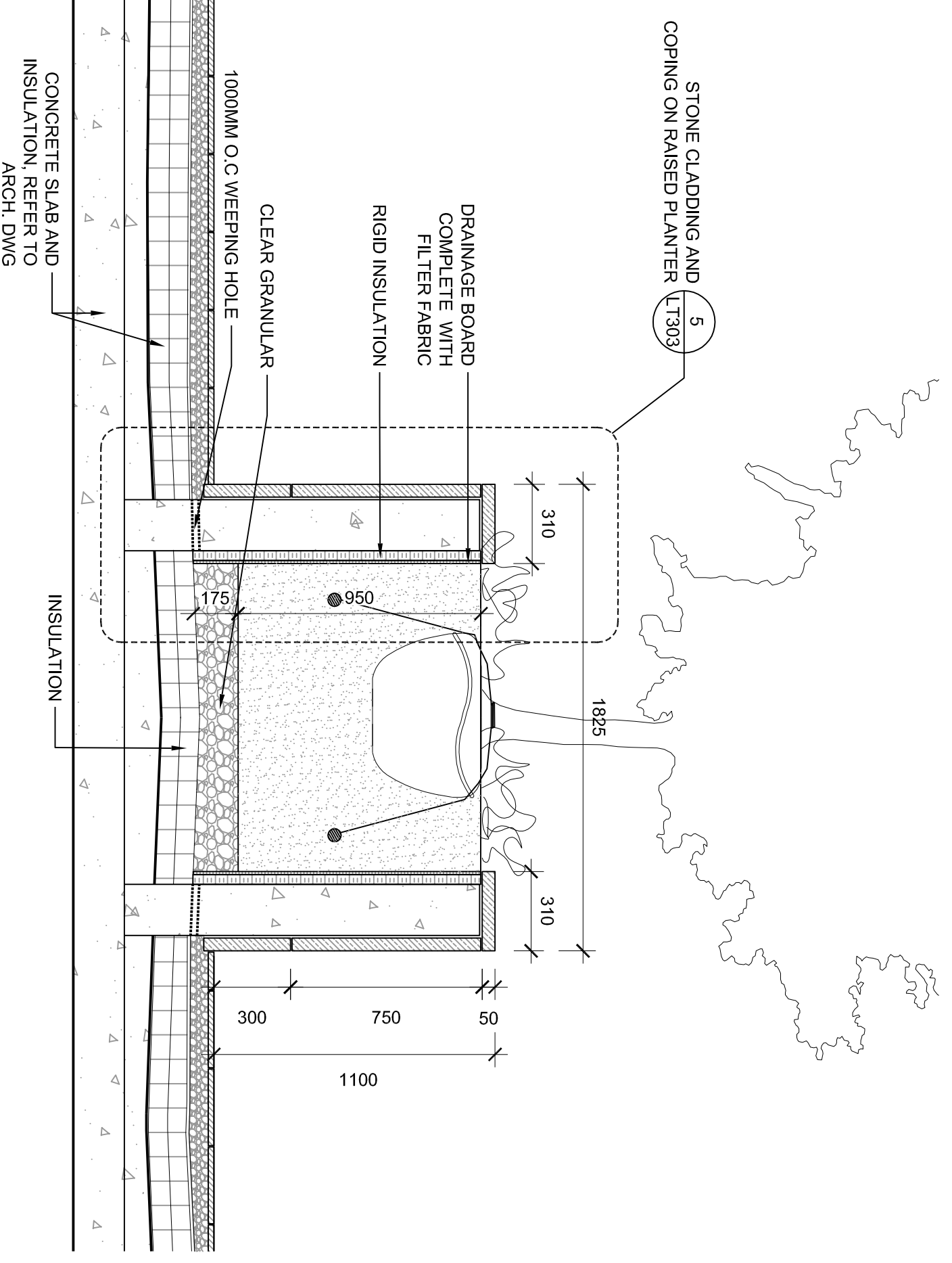

4 STONE CLAD RAISED PLANTER - SECTION
SCALE: 1 : 20

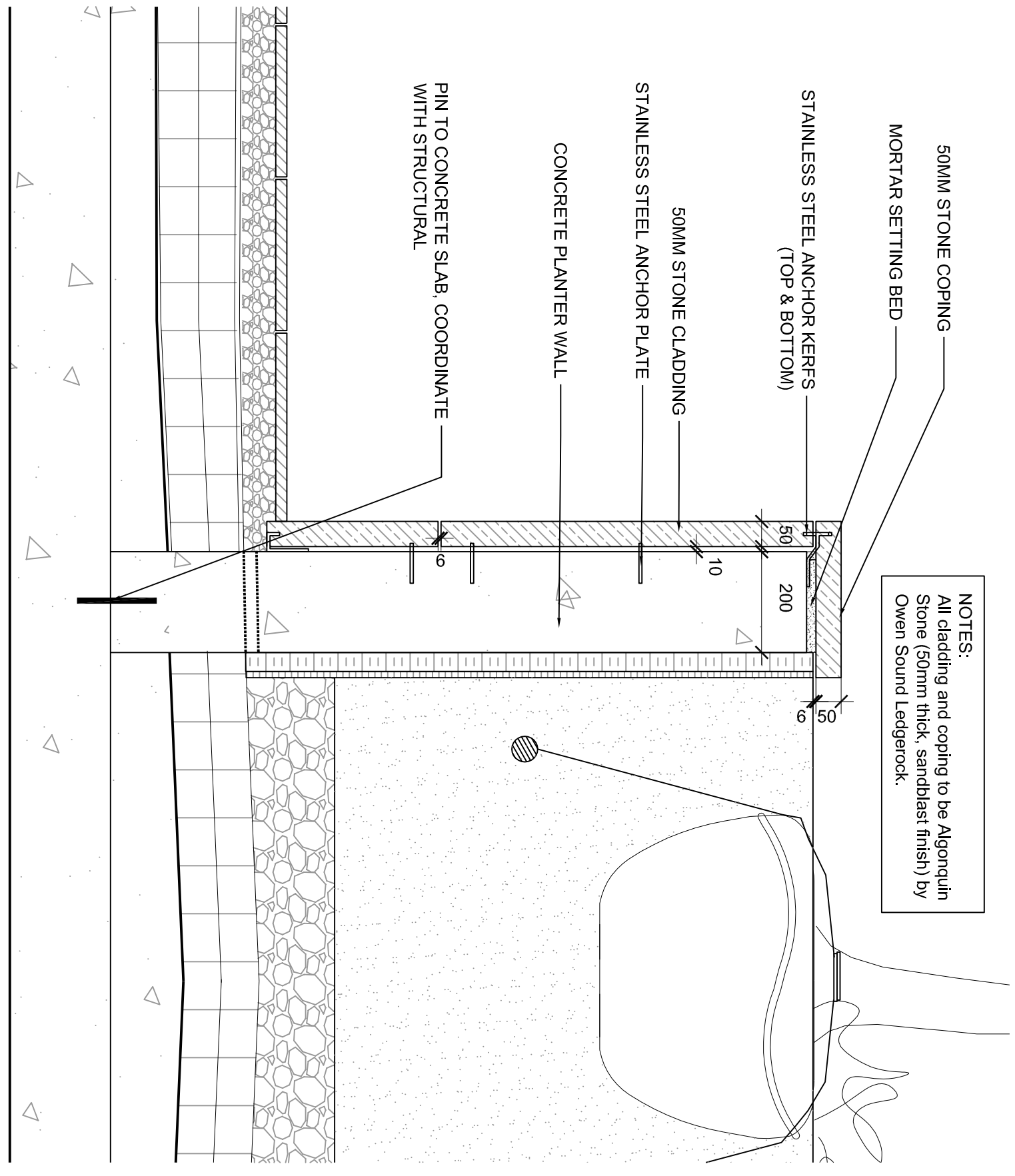

5 STONE CLADDING AND COPING ON RAISED PLANTER
SCALE: 1 : 10

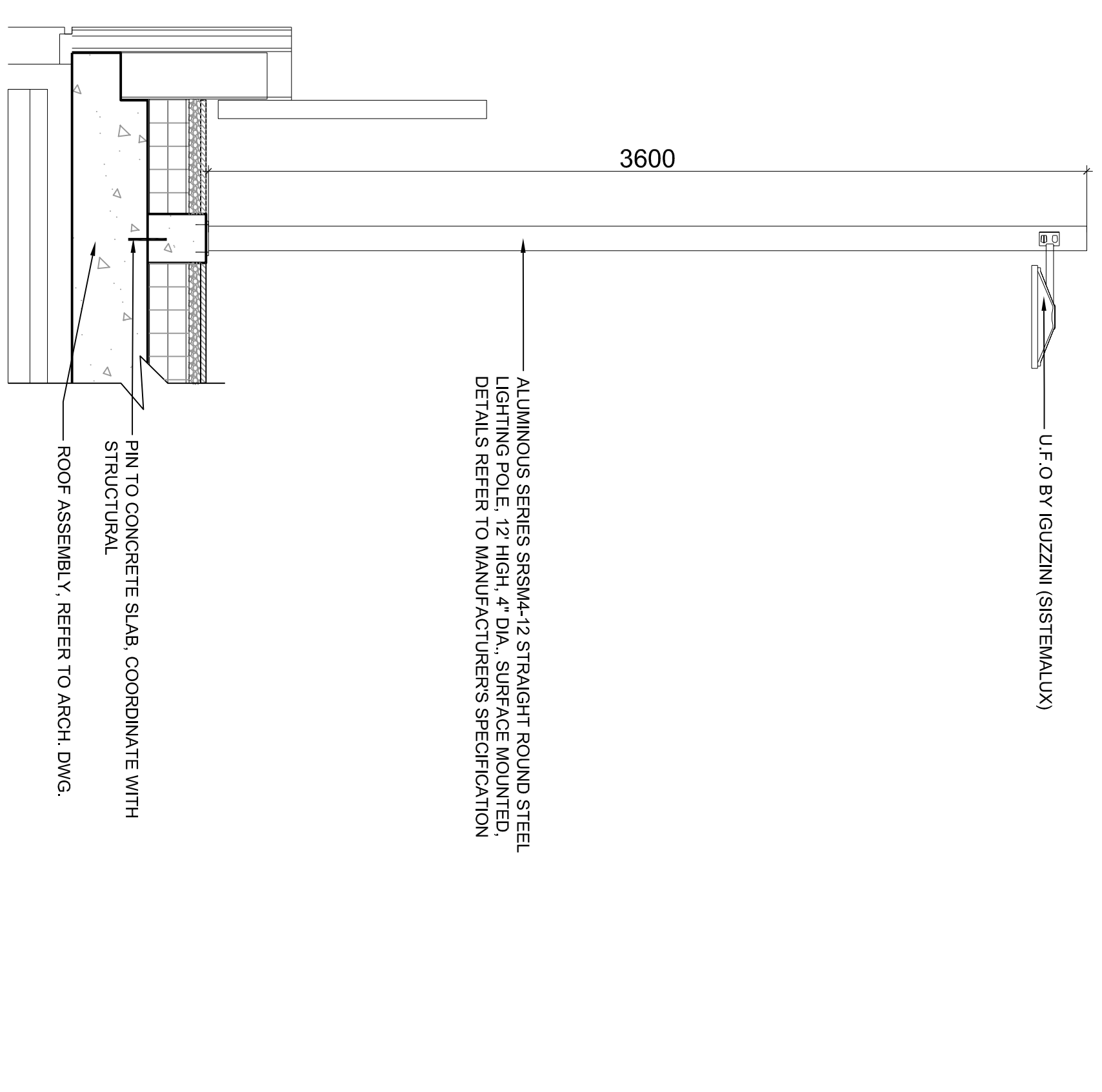

6 POLE LIGHT ON CONCRETE BASE
SCALE: 1 : 20

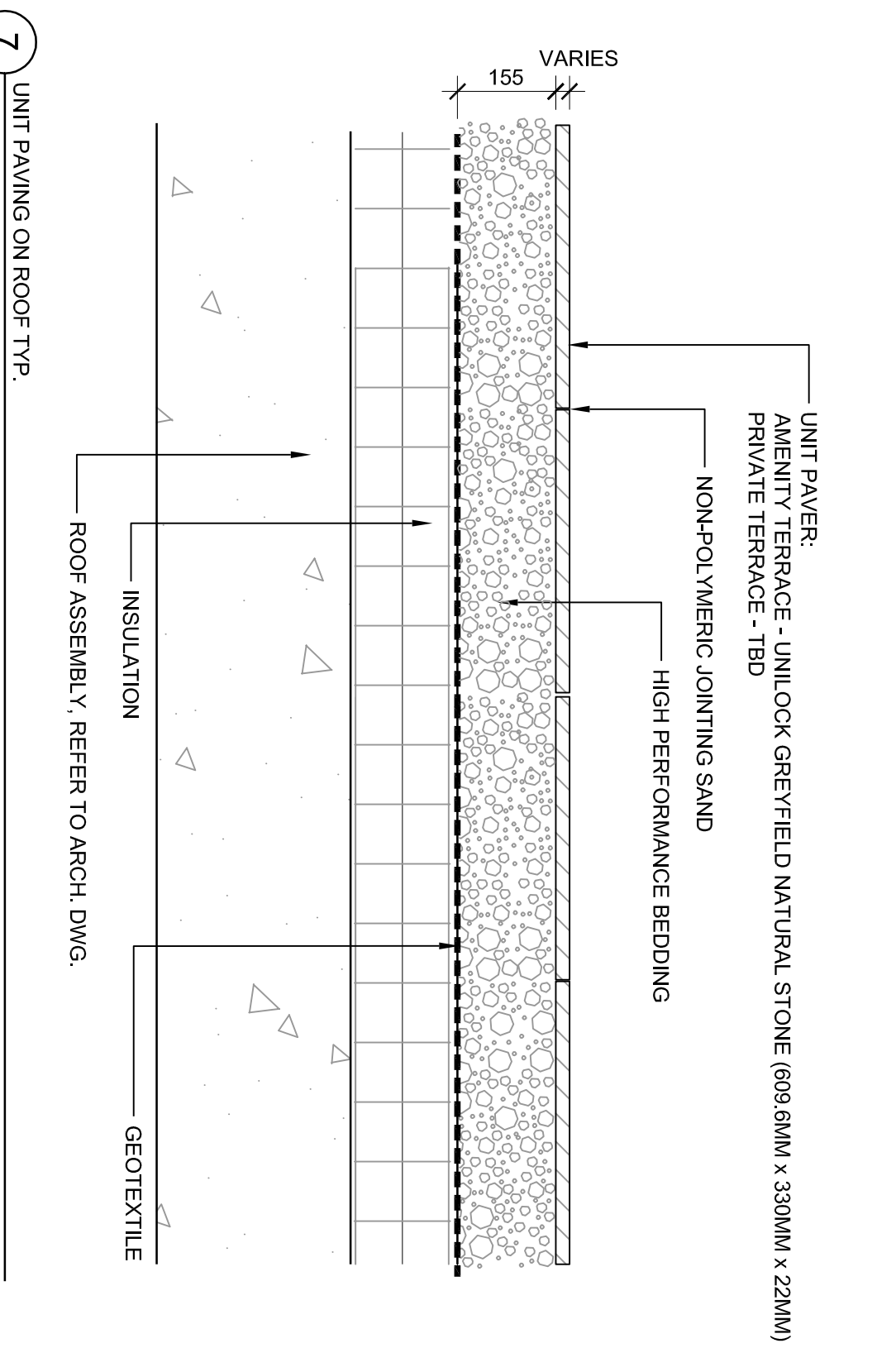

7 UNIT PAVING ON ROOF TYP.
SCALE: 1 : 10

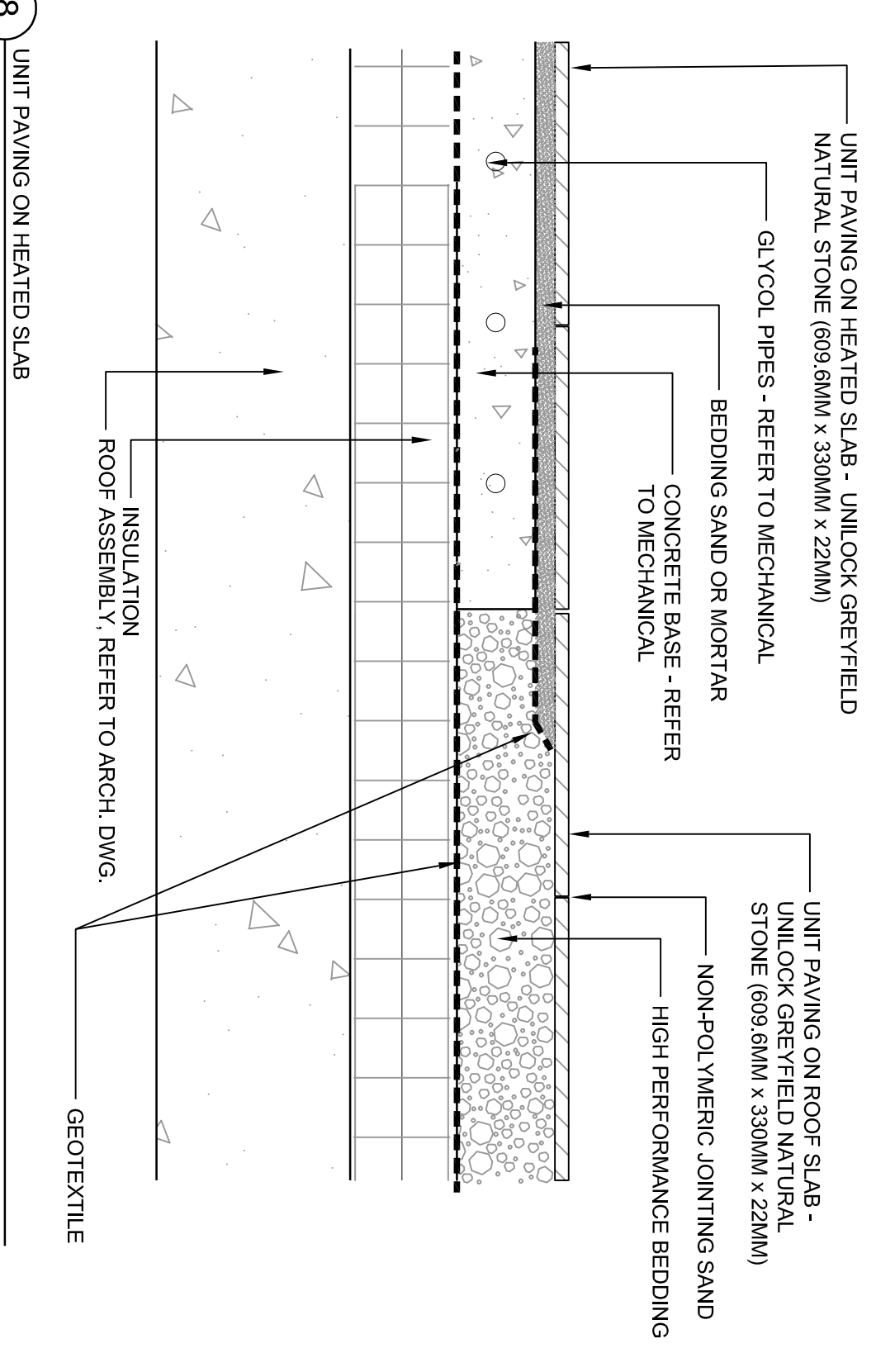

8 UNIT PAVING ON HEATED SLAB
SCALE: 1 : 10

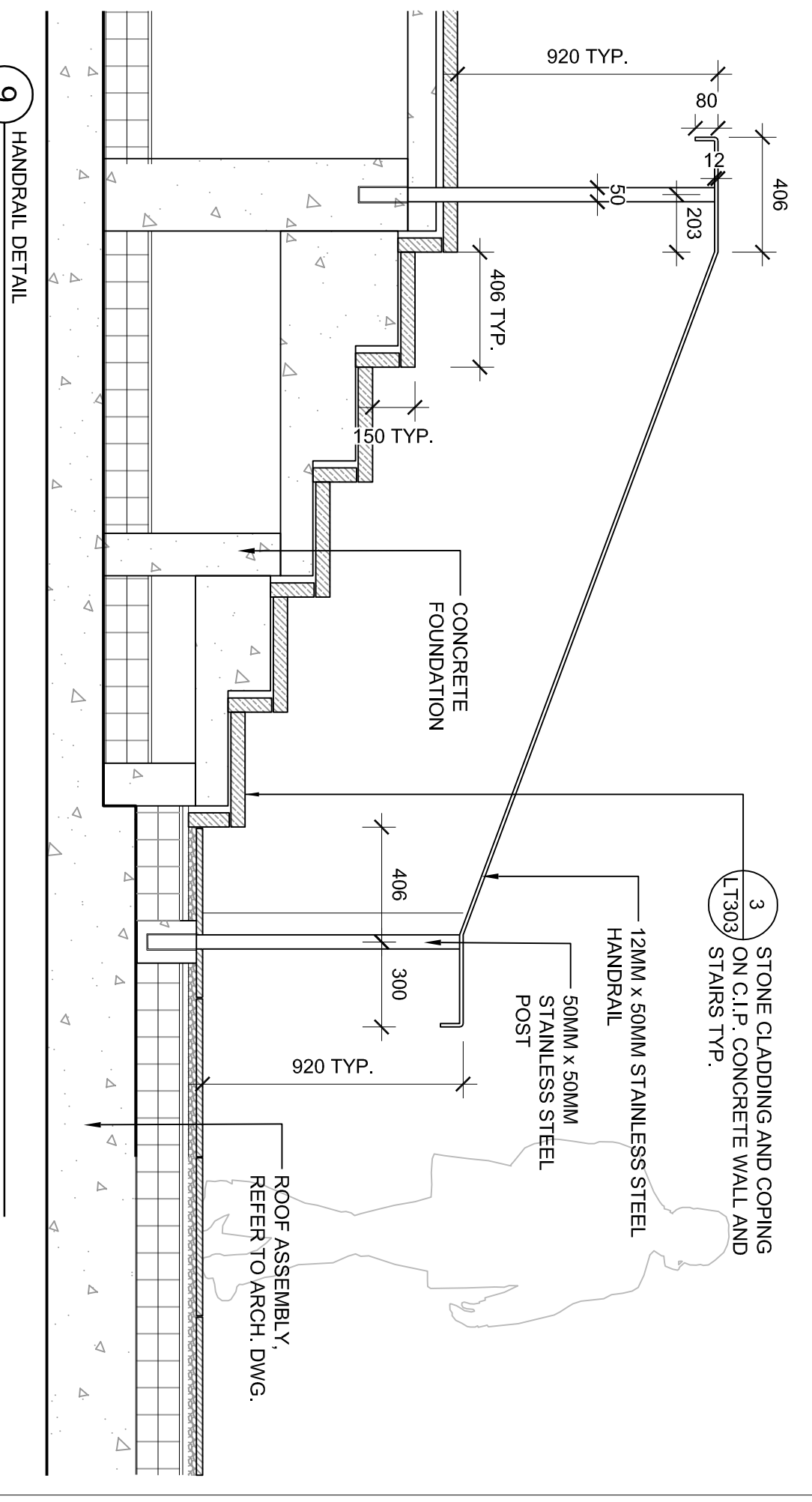

9 HANDRAIL DETAIL
SCALE: 1 : 20

LEGEND

ISSUE

1 2016-01-07 ISSUED FOR COORDINATION



Janet Rosenberg
Rosenberg & Sturberg
Landscape Architectural and Urban Design
148 West Beaver Creek, Suite 200, Richmond Hill, Ontario L4B 3N2

TRIDEL
TORONTO COMMUNITY HOUSING CORPORATION

ALEXANDRA PARK
PHASE 1A

LANDSCAPE DETAILS

SCALE: AS SHOWN
DRAWN: HL
CHECKED: GW
PROJECT NUMBER: 13-101
DRAWING DATE: 2014-10-17

LT303