

THIS DRAWING IS TO BE READ IN CONJUNCTION WITH SCHEMATIC DRAWINGS.

ACOUSTIC NOTES:

- 1) ALL RISER ANCHORS MUST INCLUDE 25MM THICK NSN ISOLATION PADS. THE PADS ARE TO BE HELD IN PLACE WITH HORIZONTAL STEEL PLATES WELDED TO BRACKETS THAT ARE IN TURN WELDED TO THE RISER.
- 2) WHERE RISERS ARE SUPPORTED BY T-CLAMPS RATHER THAN ANCHORS, NSN PADS ARE TO BE INCLUDED BELOW THE T-CLAMP.
- 3) ANY PIPE GUIDES USED IN CONNECTION WITH EXPANSION JOINTS OR LOOPS ARE TO BE THE PRE-FABRICATED TYPE WITH INTEGRAL RUBBER ISOLATION.

NOTES:

- ① 19" CHUS & 19" HUS
- ② 25" CHUS & 19" HUS
- ③ 25" CHUS & 25" HUS
- ④ 19" CHUR & 19" HUR

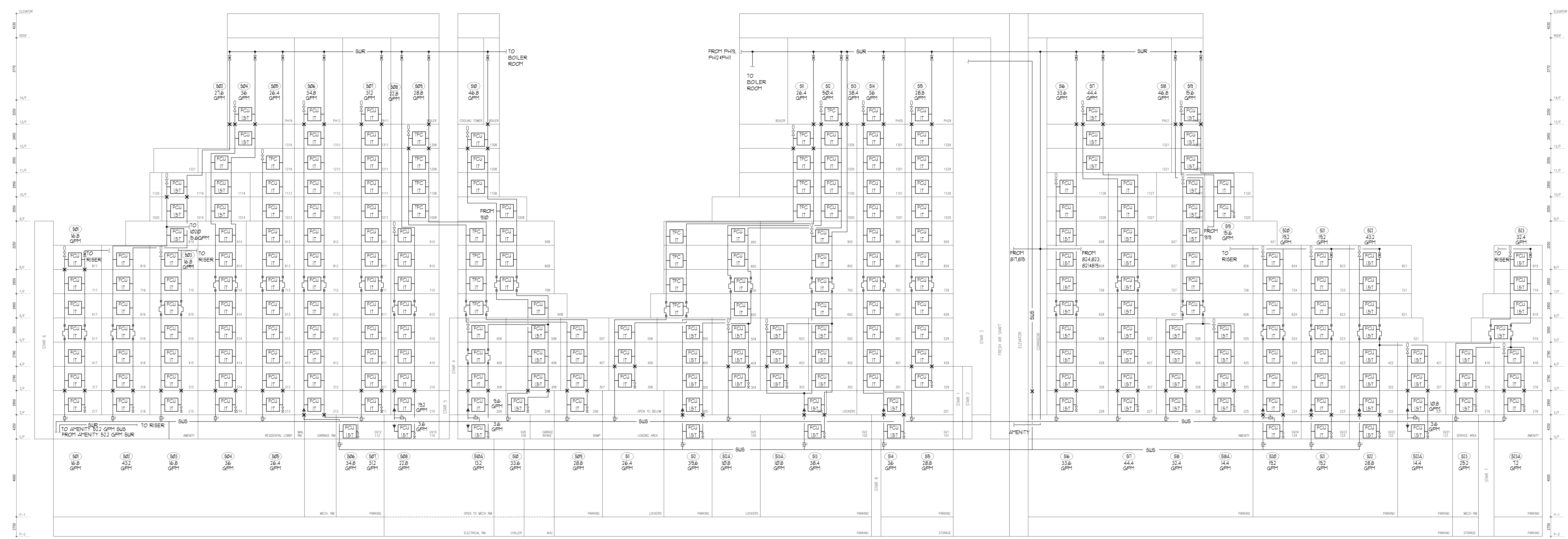

NO.	DESCRIPTION	DATE	BY

NO.	REVISIONS	DATE	BY

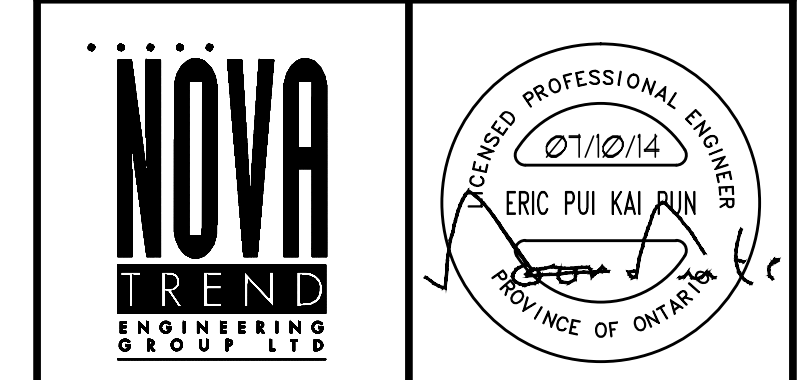

175 West Beaver Creek Road, Unit 31
 Richmond Hill, Ontario L4B 3M1
 Tel: 905-882-5445
 Fax: 905-882-5441
 Email: cad@novatrans.com

PROJECT TITLE:
SYSTEM WATER RISER DIAGRAM

PROJECT FILE:
ALEXANDRA PARK

DATE: FEB, 13 2013
 DRAWN BY: G.S.
 CHECKED BY: E.P.
 SCALE: N.T.S.
 DRAWING NUMBER: M-34
 OF 33