

1 DETAIL - TYPICAL CORRIDOR COVE LIGHTING
SCALE 1:5

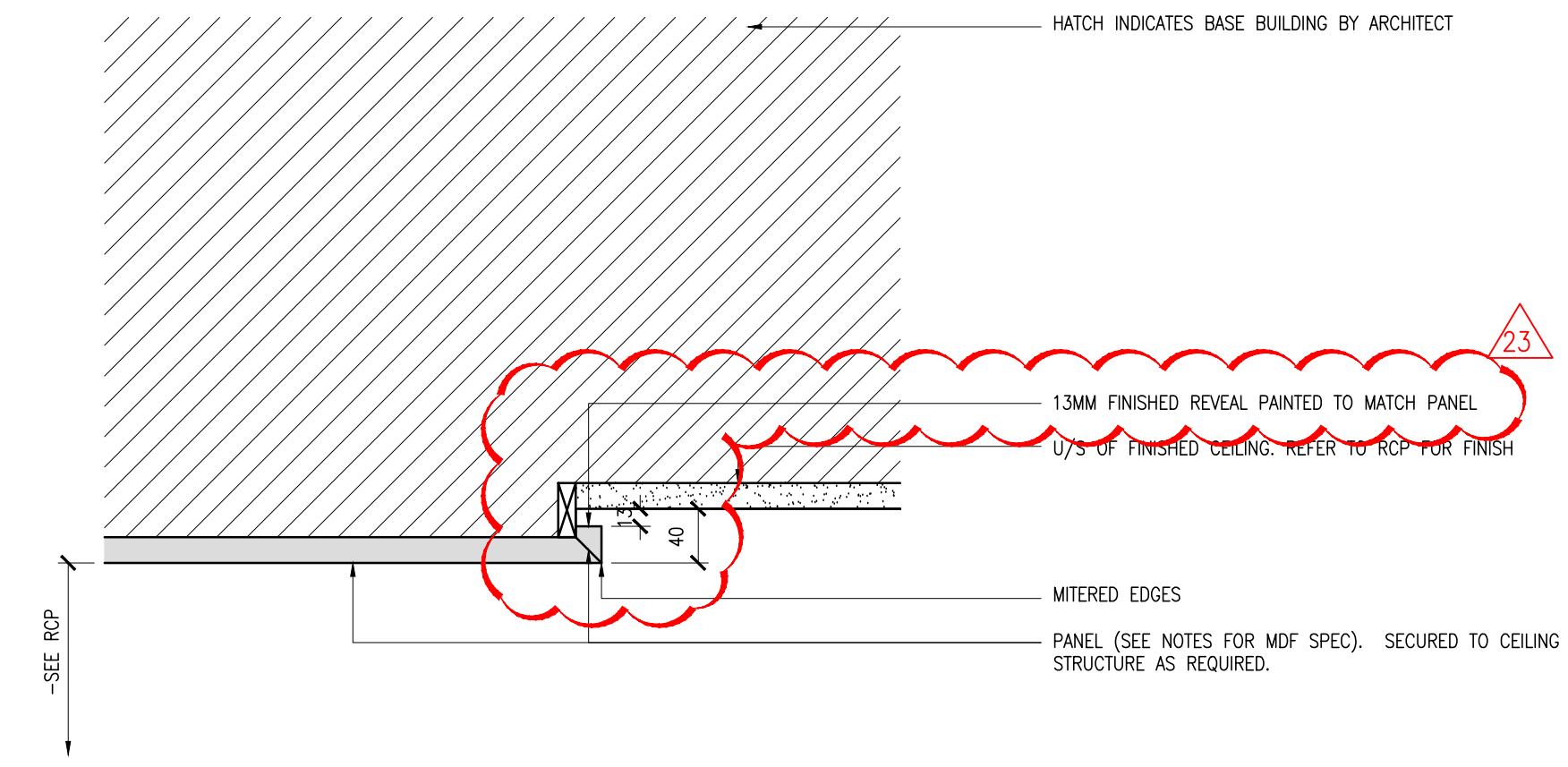

2 DETAIL - TYPICAL CORRIDOR PANELLED CEILING
SCALE 1:5

3 RESERVED
SCALE 1:5

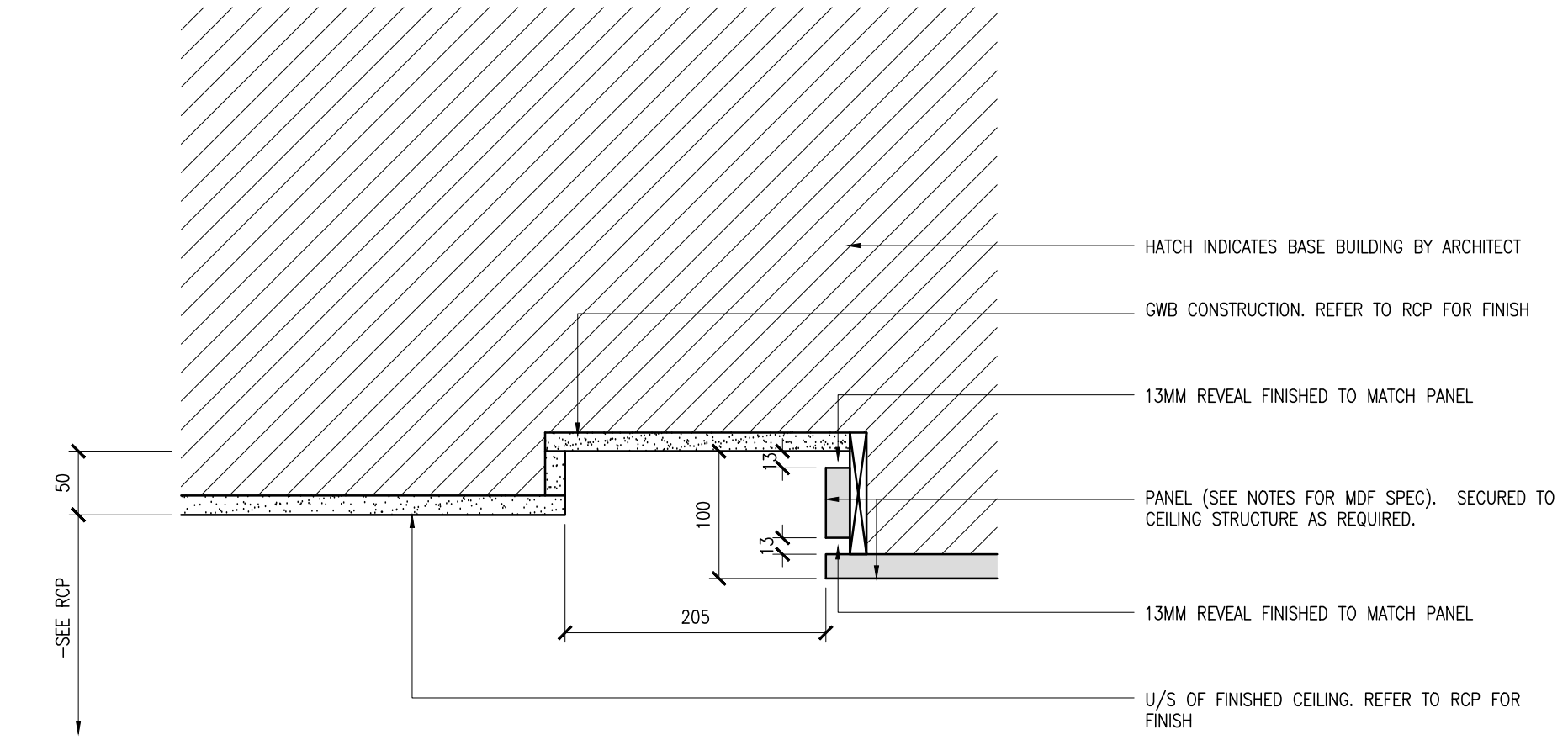

4 DETAIL: P1 FITNESS AREA PANELLED CEILING
SCALE 1:5

Notes:

- CONTRACTOR AND ALL SUB-TRADES SHALL VERIFY ALL SITE DIMENSIONS. ALL DRAWINGS, DETAILS AND SPECIFICATIONS AND REPORT ANY DISCREPANCIES TO THE INTERIOR DESIGNER IN WRITING FOR APPROVAL BEFORE PROCEEDING WITH THE WORK.
- CONTRACTOR AND SUB-CONTRACTORS, BEFORE PROCEEDING WITH WORK, MUST SUBMIT ALL NECESSARY SAMPLES FOR APPROVAL OF QUALITY AND FINISH TO THE INTERIOR DESIGNER.
- CONTRACTOR MUST COMPLY WITH THE CONTRACT DOCUMENTS, PERFORMANCE REQUIREMENTS, APPLICABLE CODES AND REGULATIONS.
- ALL DRAWINGS AND WRITTEN MATERIAL HEREIN CONSTITUTES THE ORIGINAL AND UNPUBLISHED WORK OF "I BY IV DESIGN ASSOCIATES INC." AND MAY NOT BE DUPLICATED, USED OR DISCLOSED WITHOUT PRIOR WRITTEN CONSENT OF "I BY IV DESIGN ASSOCIATES INC."
- DRAWINGS NOT TO BE SCALED.

Issue:

06 ISSUED FOR CLIENT REVIEW	16.01.15
07 ISSUED FOR TENDER	16.03.15
08 ISSUED FOR ADDENDUM	16.09.20
10 ISSUED FOR CONSTRUCTION	17.06.19
13 SITE INSTRUCTION #03	17.11.10
14 SITE INSTRUCTION #04	18.03.07
16 SITE INSTRUCTION #06	18.05.04
23 SITE INSTRUCTION #15	18.11.09
-	-
-	-
-	-
-	-

Hines TRIDEL

AQUAVISTA
AT BAYSIDE TORONTO

1 EDGEWATER DRIVE, TORONTO ONTARIO

77 MOWAT AVENUE, SUITE 100
TORONTO, ONTARIO M6K 3G3 - CANADA
T + 1 416 531 2224
12 DEARBORN STREET
NEW YORK, NEW YORK 10013 - USA
T + 1 212 362 4952

Drawing Title:
TYPICAL CEILING
DETAILS

Our Project Number:
14008
Designed By: DMJ/R, VVJ, SG
Detailed By: DMJ/R, VVJ, SG, BP
Drawing Number:

ID9.3